

CAROLINE COUNTY

LOCATION

INSERT 51A3

INSERT 51A9

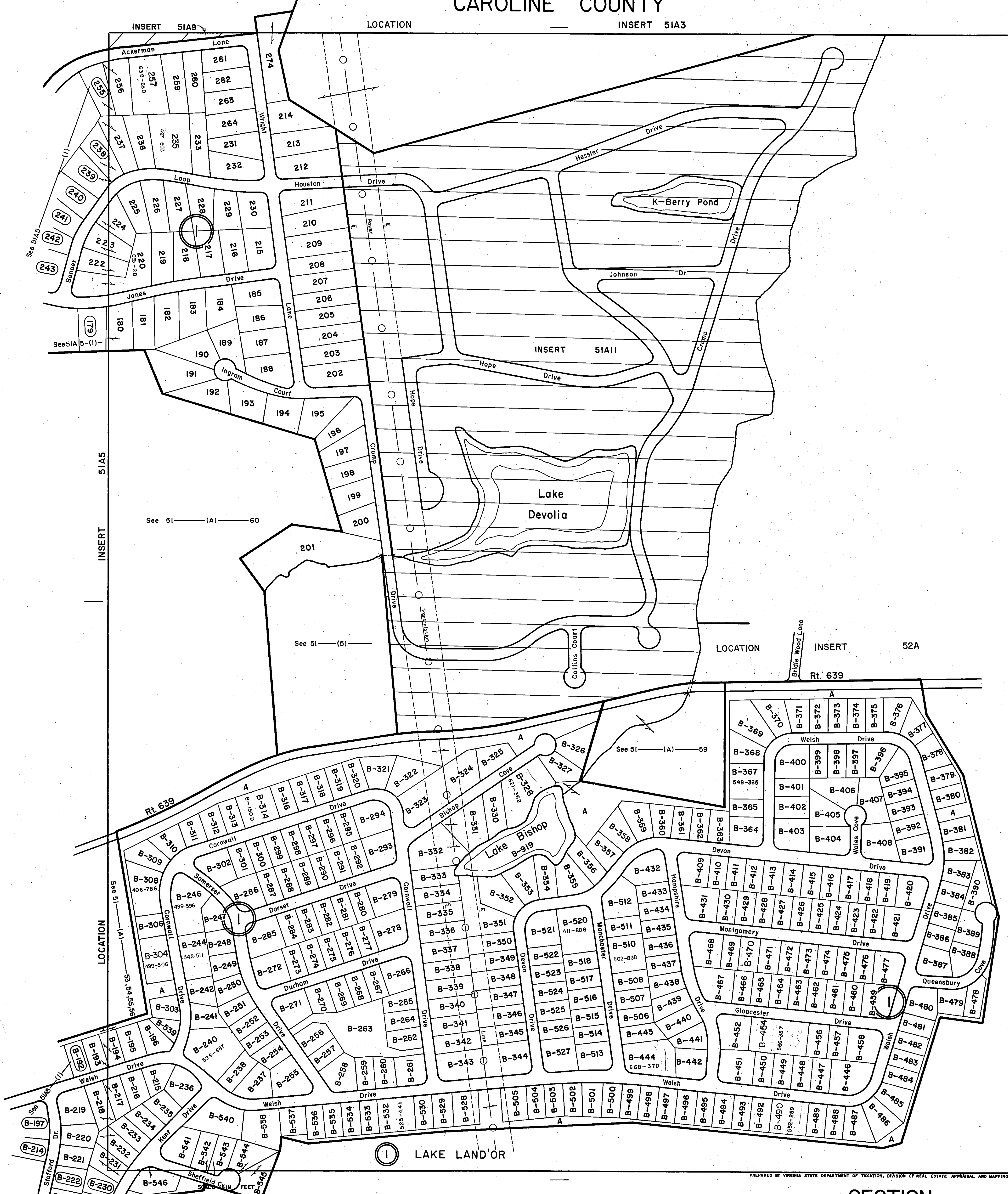

REVISID: 12-93 96 98 99 00

MADISON DISTRICT

SECTION INSERT 51A6

PREPARED BY VIRGINIA STATE DEPARTMENT OF TAXATION, DIVISION OF REAL ESTATE APPRAISAL AND MAPPING