

CAROLINE COUNTY

38

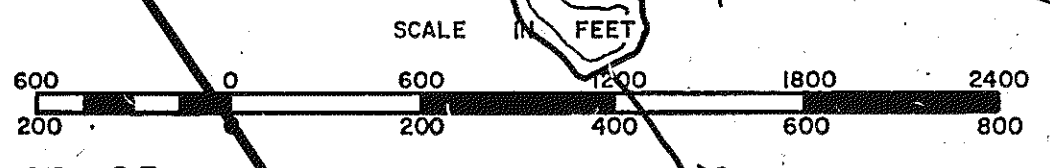
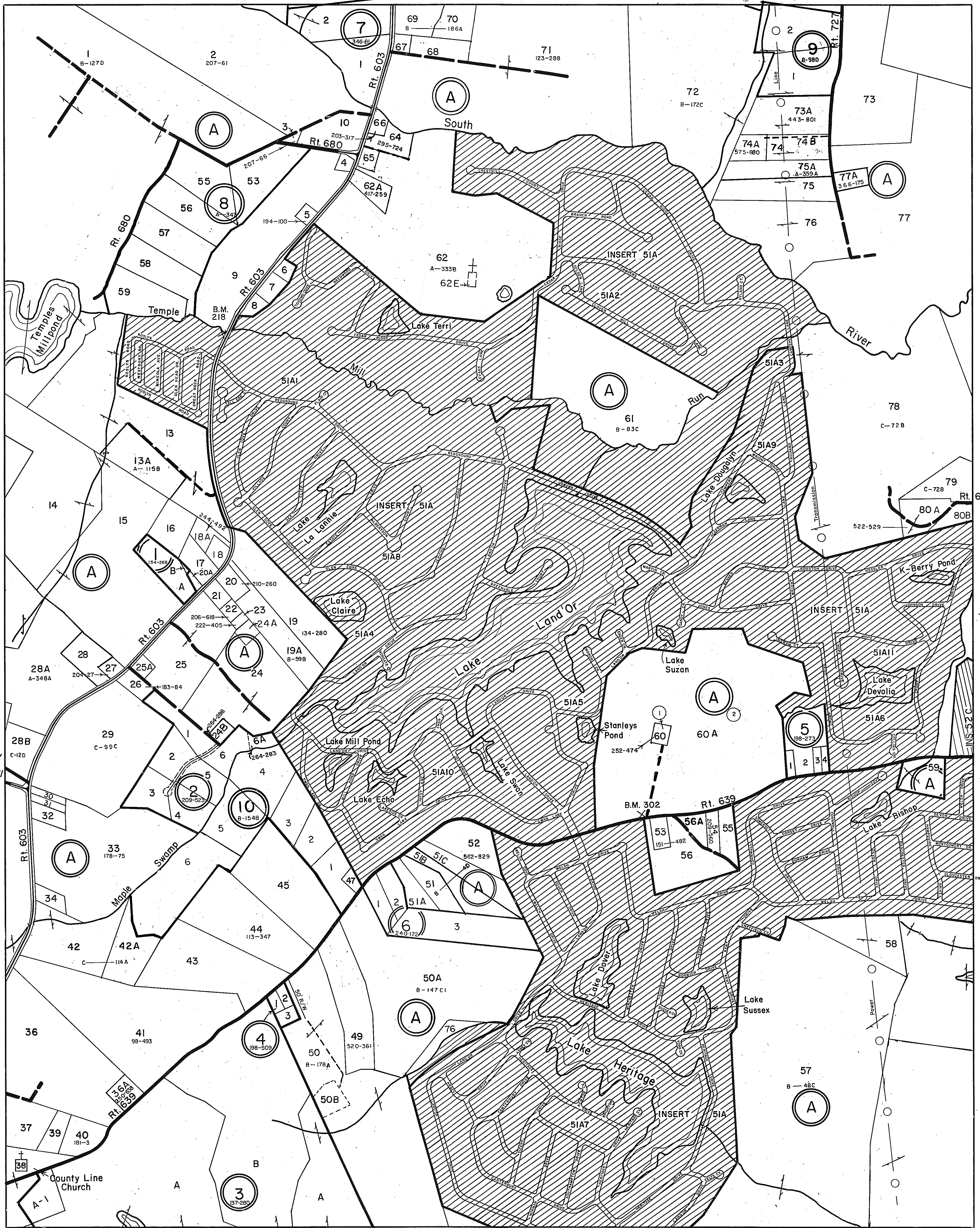

REVISED: 12-80, 81, 82, 83, 85, 86, 87, 88, 89, 90, 92, 94, 95, 97, 98, 99, 02, 03, 05

MADISON DISTRICT

SECTION 51
INSERT

PREPARED BY VIRGINIA STATE DEPARTMENT OF TAXATION, DIVISION OF REAL ESTATE APPRAISAL AND MAPPING