

CAROLINE COUNTY

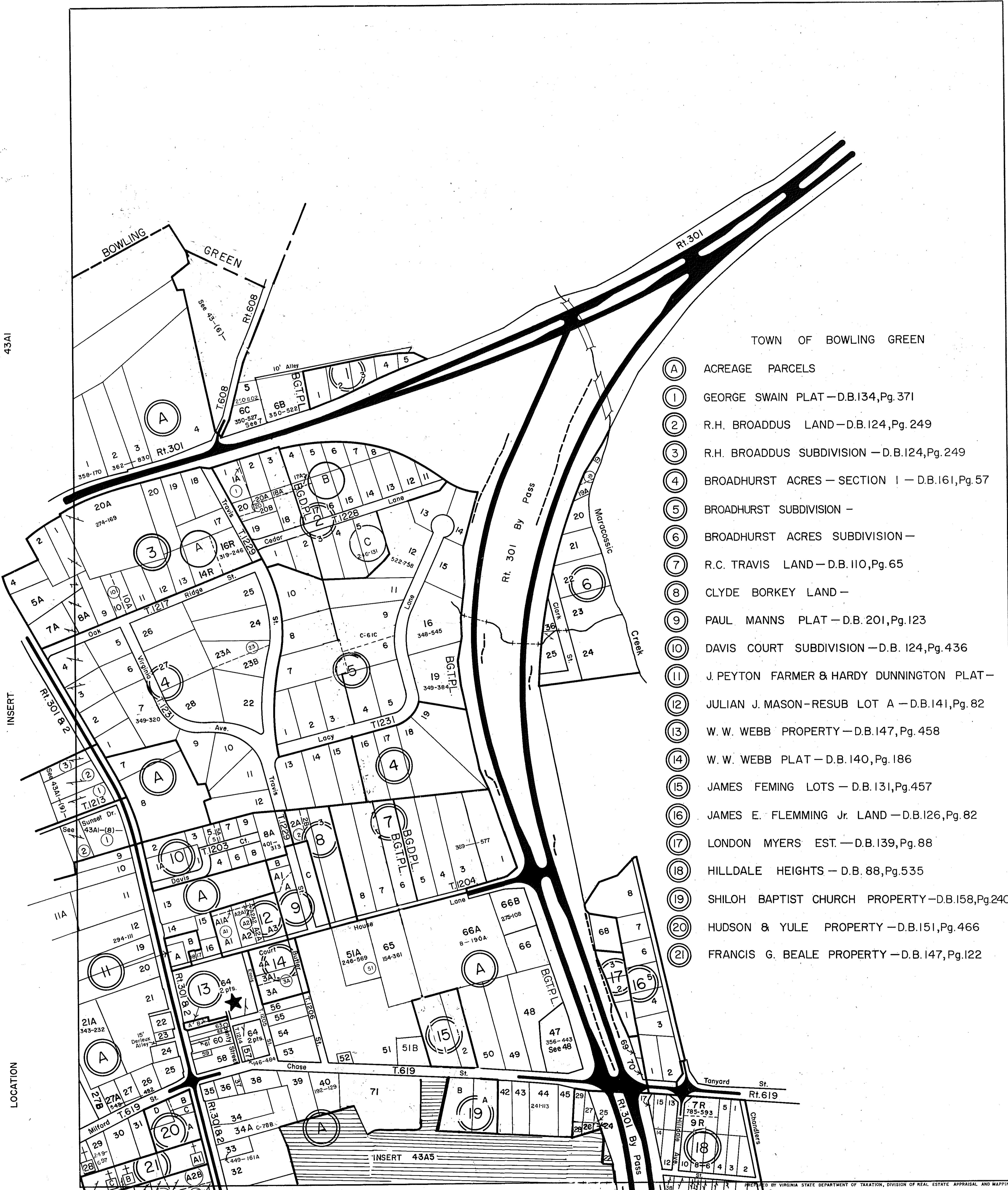

TOWN OF BOWLING GREEN

- (A) ACREAGE PARCELS
- (1) GEORGE SWAIN PLAT—D.B.134, Pg. 371
- (2) R.H. BROADDUS LAND—D.B.124, Pg. 249
- (3) R.H. BROADDUS SUBDIVISION—D.B.124, Pg. 249
- (4) BROADHURST ACRES—SECTION 1—D.B.161, Pg. 57
- (5) BROADHURST SUBDIVISION—
- (6) BROADHURST ACRES SUBDIVISION—
- (7) R.C. TRAVIS LAND—D.B.110, Pg. 65
- (8) CLYDE BORKEY LAND—
- (9) PAUL MANNS PLAT—D.B. 201, Pg. 123
- (10) DAVIS COURT SUBDIVISION—D.B. 124, Pg. 436
- (11) J. PEYTON FARMER & HARDY DUNNINGTON PLAT—
- (12) JULIAN J. MASON—RESUB LOT A—D.B.141, Pg. 82
- (13) W. W. WEBB PROPERTY—D.B.147, Pg. 458
- (14) W. W. WEBB PLAT—D.B.140, Pg. 186
- (15) JAMES FEMING LOTS—D.B.131, Pg. 457
- (16) JAMES E. FLEMMING Jr. LAND—D.B.126, Pg. 82
- (17) LONDON MYERS EST.—D.B.139, Pg. 88
- (18) HILLDALE HEIGHTS—D.B. 88, Pg. 535
- (19) SHILOH BAPTIST CHURCH PROPERTY—D.B.158, Pg. 240
- (20) HUDSON & YULE PROPERTY—D.B.151, Pg. 466
- (21) FRANCIS G. BEALE PROPERTY—D.B.147, Pg. 122