

CAROLINE COUNTY

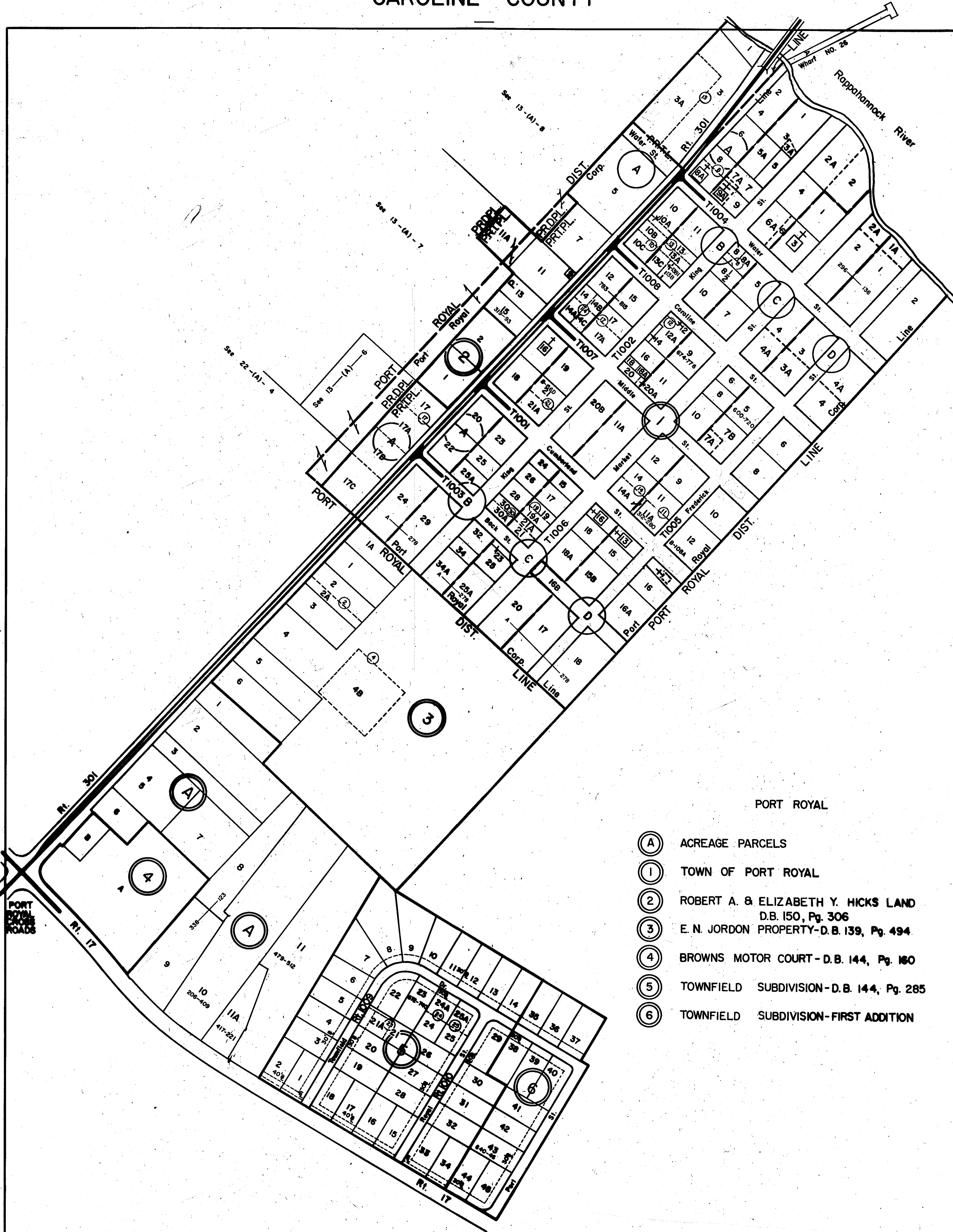

- (A) ACREAGE PARCELS
- (1) TOWN OF PORT ROYAL
- (2) ROBERT A. & ELIZABETH Y. HICKS LAND  
D.B. 150, Pg. 306
- (3) E. N. JORDON PROPERTY-D.B. 139, Pg. 494
- (4) BROWNS MOTOR COURT - D.B. 144, Pg. 160
- (5) TOWNFIELD SUBDIVISION - D.B. 144, Pg. 285
- (6) TOWNFIELD SUBDIVISION - FIRST ADDITION

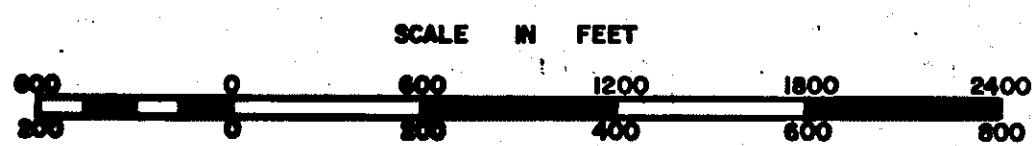

PORT ROYAL DISTRICT TOWN

SECTION 13A  
INSERT 13A